

Planters Type 33.0



CHARACTERISATIONS

MATERIAL Cast stone

WEIGHT 3430 kg



Designer: Urba-Style (BE)

COLOUR

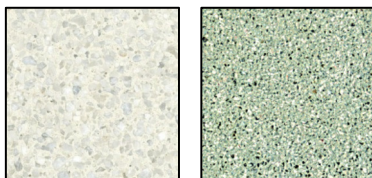

FINISHING Acid etched

Waterproof and anti-graffiti protection

HANDLING

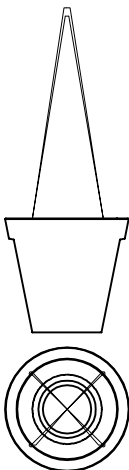

GEOMETRY

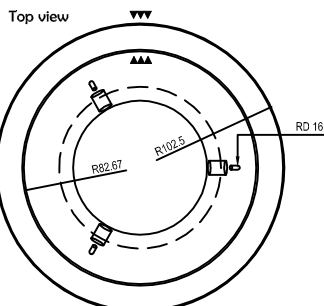

Front view

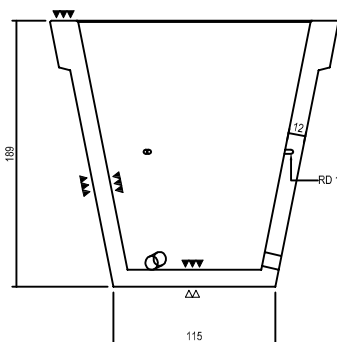

Detail

Scale 0 cm 40 cm

