

Planters Type 16.0



CHARACTERISATIONS

MATERIAL Cast stone
FIXING Freestanding
WEIGHT 110 kg



Designer: Urba-Style (BE)

COLOUR

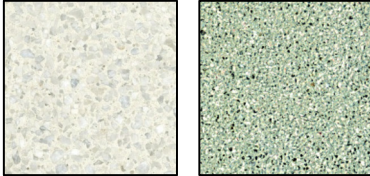

FINISHING Acid etched

Waterproof and anti-graffiti protection

GEOMETRY

Top view

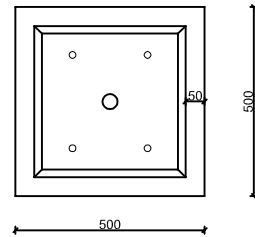

Front view

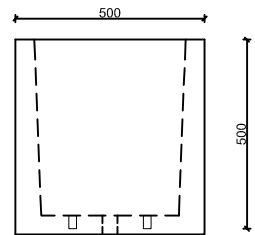

HANDLING

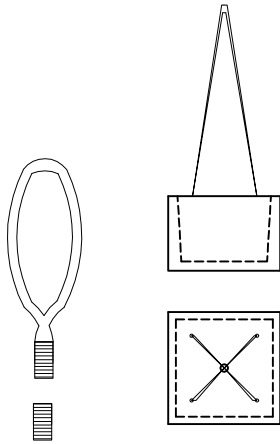

M12

Detail

Scale 0 cm 40 cm

