

Bench B.FLEX Type 5

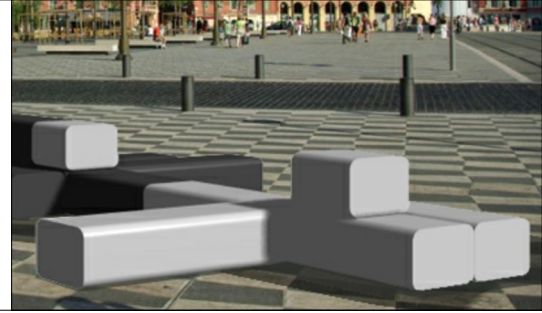

CHARACTERISATIONS

MATERIAL Cast stone
FIXING 2x M12 Shelve - length 200 mm
WEIGHT 220 kg



Designer: Marine Peyre (FR)

COLOUR

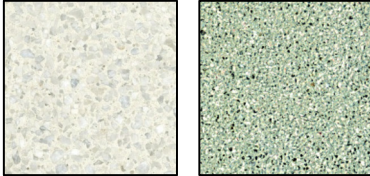

FINISHING

Acid etched

Waterproof and anti-graffiti protection

HANDLING

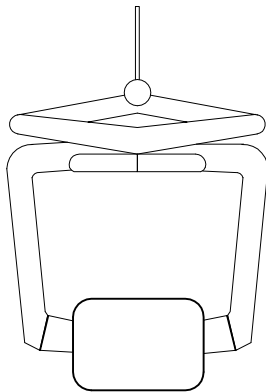

GEOMETRY

Top view

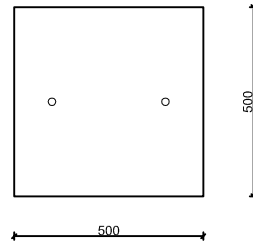

Front view

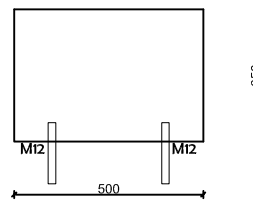

Side view

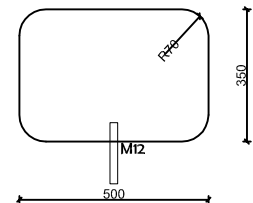

Detail

Scale 0 cm  40 cm

