

Bench B.FLEX Type 3

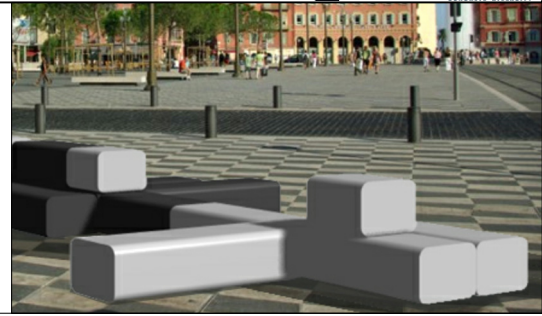

CHARACTERISATIONS

MATERIAL Cast stone
FIXING 2x M12 Shelve - length 200 mm
WEIGHT 657 kg



Designer: Marine Peyre (FR)

COLOUR

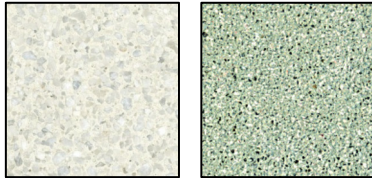

FINISHING

Acid etched

Waterproof and anti-graffiti protection

HANDLING

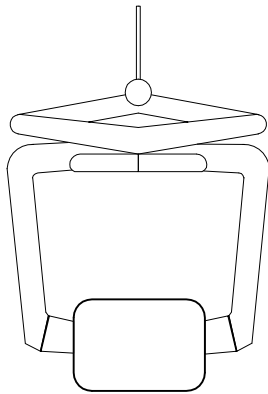

GEOMETRY

Top view



1500

Front view

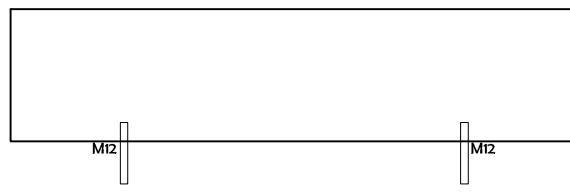

1500

Side view

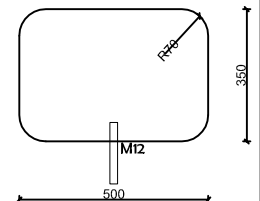

Detail

Scale 0 cm  40 cm

